

1 INPUTS

Gen

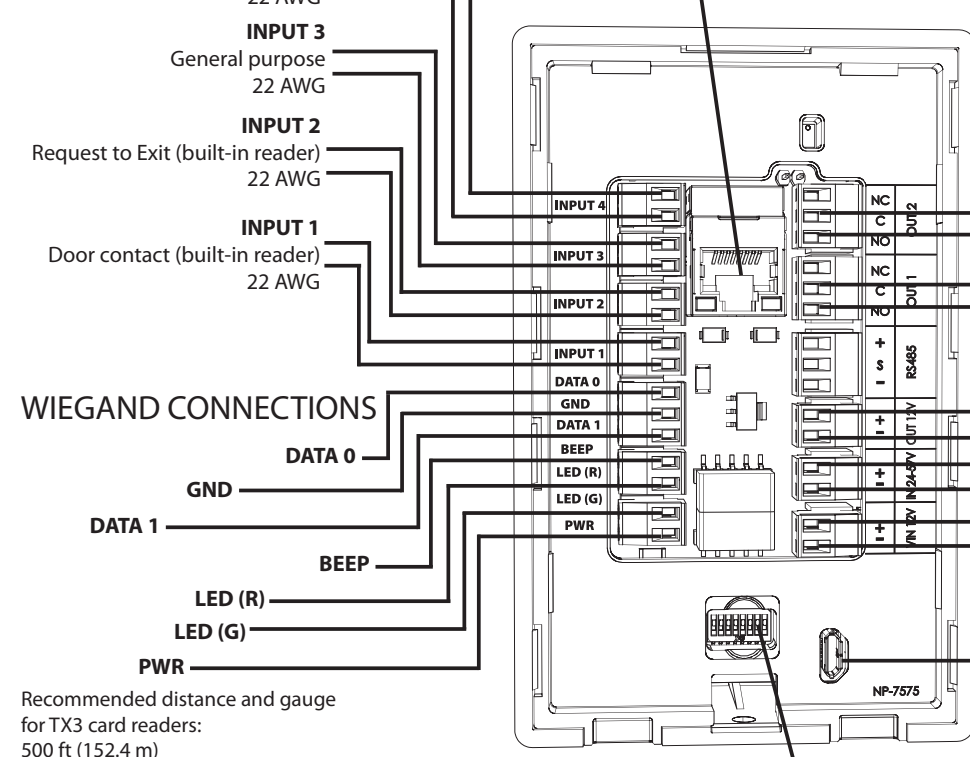

Use 20 AWG for 500 ft (152.4 m)
Use 22 AWG for 250 ft (76.2 m)
For other card readers, consult
your reader installation manual for
recommended distances and gauges.

Outputs 1 and 2 are rel
programmable output

programmable outputs with the following characteristics:

- normally open (NO)
- normally closed (NC) available
- 30 VDC/2 A
- 125 VAC/0.5 A

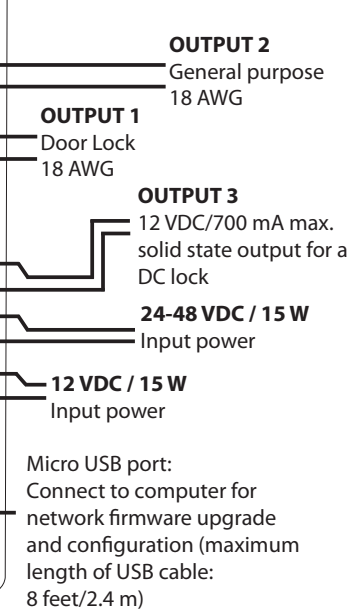

Address 1 Address 2 Address 3 Address 4



Note: Use only one of the power inputs: PoE, 24-48 VDC, or 12 VDC.

Wiring Requirements

- RS-485 wiring maximum length:

- RS-485 wiring maximum length: 4000 ft (1219.2 m)

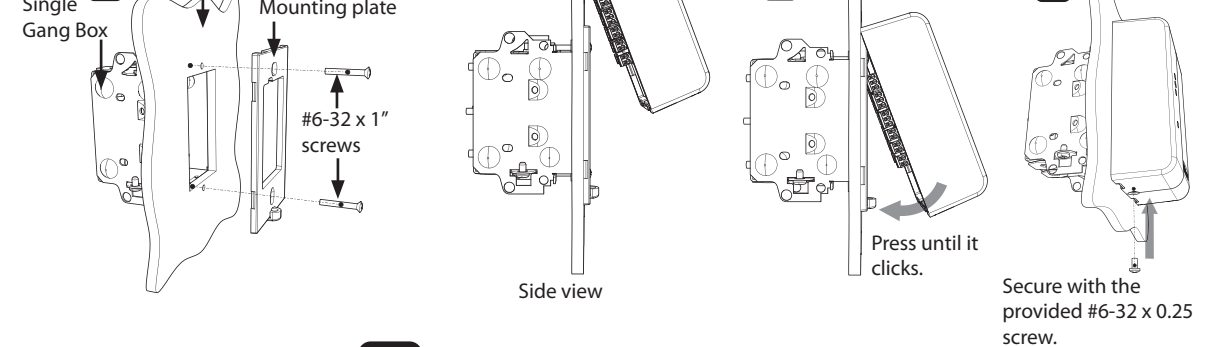

22 AWG
Maximum length:

shielded twisted pair

120 Ω

all common reference

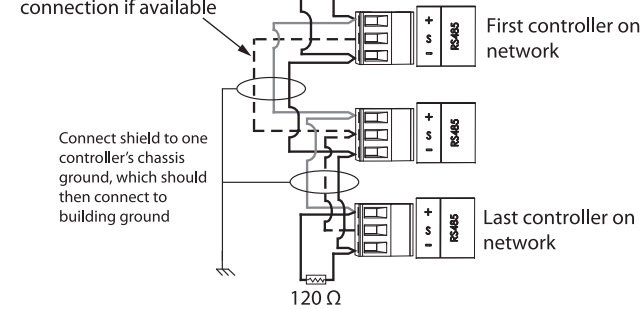

A Remove the screw from the bottom of

