



Models: MH-25R & MH-S25WA

Description

Mircom's MH-25 Series mini horns are compact electronic alarm appliances that are ideal for alarm signalling in individual rooms, apartments, hotels and offices where attractive appearance and dependable performance are prime concerns. When activated, the MH-25 Series mini-horns produce a high sound output of over 89 dBA at 10 feet with a minimum current draw of 45 milliamps at 24 VDC (unfiltered) on the non silenceable models. Designed as alert or alarm signal appliances for use with any conventional Fire Alarm Control panel, the MH-Series mini horns are available in a standard version (MH-25) and a Silenceable version (MH-S25).

The MH-S25 versions are silenceable mini horns equipped with a "Silence" push button and a red LED to indicate "active signal circuit" when lit. The push button allows the user to silence the mini-horn for a maximum of 10 minutes upon which the mini-horn will sound again until the signal circuit is inactive or the mini horn is silenced again or the fire alarm panel is reset. Upon the fire alarm being reset, it takes approximately 25 seconds for the MH-S25 Mini-Horns to reset.

All MH-25 Series mini horns are designed for easy installation with convenient mounting to standard single gang boxes and in-out wire leads for fast connection. The front face plates are ruggedly constructed of high impact thermoplastic and are available in fire alarm red or off-white to blend with any room decor.

Features

- High sound output for enhanced audibility (over 89dBA at 10 feet) @ 24VDC
- "Silence" push button and red LED to indicate "active signal circuit" on MH-S25 versions
- 24 VDC models with wide listed voltage range, filtered DC (Non Silenceable only)
- Polarized inputs for compatibility with standard reverse polarity supervision of circuit wiring by an alarm panel
- Mounts into standard single gang box
- Flush or surface mounting options
- Compatible with sensitive detection and communication circuits
- Available in red or off-white finish

Installation Instructions

MH-25 Mini-Horn

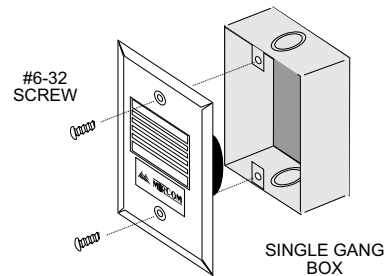

MH-S25 Silenceable Mini-Horn

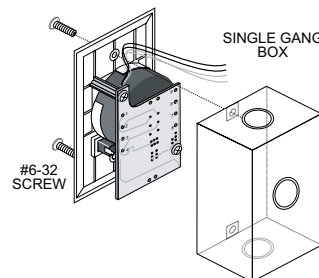

Note: The MH-25 Series mini-horns are compatible with the CSIS-202 and CNSIS-204 Conventional Signal Isolator Modules. Please refer to Cat. Sheet #5223 and #5224.



S5375
(MH-25R/
MH-25W)



S5375



7135-1477:118
(MH-25R/
MH-25W)

MEA
approved

313-97-E
(MH-25R/
MH-25W)

NOT TO BE USED FOR INSTALLATION PURPOSES.
THIS INFORMATION IS FOR MARKETING PURPOSES ONLY AND NOT INTENDED TO DESCRIBE THE PRODUCTS TECHNICALLY.

CATALOG NUMBER

5208

Specifications

MH-25R / MH-25W

Rated Voltage	16-33VDC Regulated 24Vdc/fwr		
Rated Current	45 mA		
Overall Sound Pressure Level (dBA, anechoic)	TONE	@16 V	@33 V
	Contiuous	81	87
	Temporal (via (FACP))	82	89
Directional Characteristic (represents both horizontal and vertical axes)	ANGLE	OSPL (dBA)	
	0° (on axis) -90° & 90°	0 (tr -3g)	

Sound Level in the indoor installation may vary depending upon the space surroundings

Devices are intended for dwelling use ONLY

Mircom does not recommend any changes to the factory applied finish

Operating temperature: -20°C ~ +60°C (-4°F ~ +140°F)

Plate: A.B.S

Color Selection: Red/White

Weight: 2.2 oz (63g)

Two #6-32 screws provided



54SN



63Y0



7135-1477-118



313-97-E

MH-S25R / MH-S25W

Rated Voltage	16-33VDC Regulated 24Vdc/fwr		
Rated Current	62 mA		
Overall Sound Pressure Level (dBA, anechoic)	TONE	@16 V	@33 V
	Contiuous	78	82
	Temporal (via (FACP))	83	86
Directional Characteristic (represents both horizontal and vertical axes)	ANGLE	OSPL (dBA)	
	0° (on axis) -90° & 90°	0 (r -3ef)	

Sound Level in the indoor installation may vary depending upon the space surroundings

Devices are intended for dwelling use ONLY

Mircom does not recommend any changes to the factory applied finish

Operating temperature: -20°C ~ +60°C (-4°F ~ +140°F)

Current: 15.5mA STBY



63Y0

Typical Wiring diagrams

MH-25 Mini-Horn

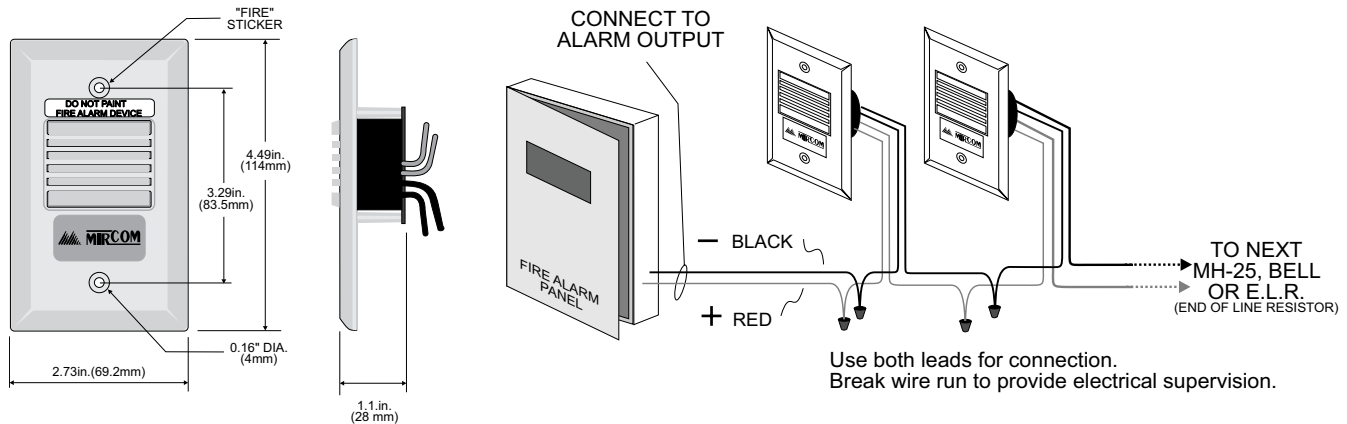

MH-S25 Silenceable Mini-Horn

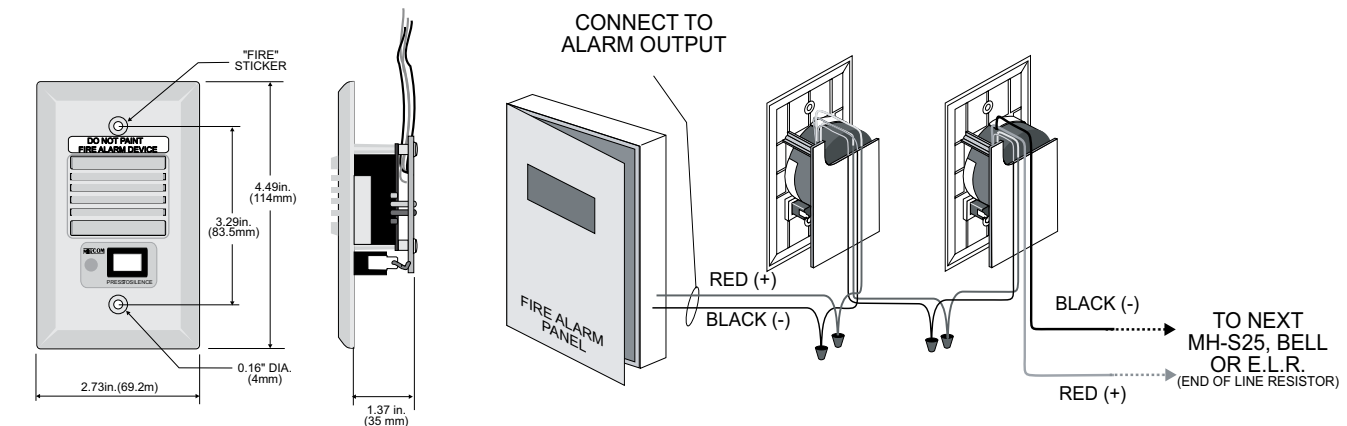

Ordering Information

Model	Description	Color	Approval Listings
MH-25R	Mini-Piezo	Red	UL, ULC, CSFM, MEA
MH-25W	Mini-Piezo	White	UL, ULC, CSFM, MEA
MH-S25RA	Silenceable Mini-Piezo	Red	ULC
MH-S25WA	Silenceable Mini-Piezo	White	ULC



Canada
25 Interchange Way
Vaughan, Ontario L4K 5W3
Telephone: (905) 660-4655
Fax: (905) 660-4113

U.S.A.
4575 Witmer Industrial Estates
Niagara Falls, NY 14305
Toll Free: (888) 660-4655
Fax Toll Free: (888) 660-4113



THIS INFORMATION IS FOR MARKETING PURPOSES ONLY AND NOT INTENDED TO DESCRIBE THE PRODUCTS TECHNICALLY.

For complete and accurate technical information relating to performance, installation, testing and certification, refer to technical literature. This document contains intellectual property of Mircom. The information is subject to change by Mircom without notice. Mircom does not represent or warrant correctness or completeness.