



Description

MGC's FHS-400C ceiling mount horn/strobes offer an audible/visual solution that delivers exceptional energy efficiency in a compact design. Utilizing advanced LED technology, the FHS-400C Series LED horn/strobes provide a lower current draw which allows for more devices on a NAC circuit while reducing the number of external power supplies required.

The FHS-400C horn/strobes offer a wide range of audible/visual settings in a single compact device. The audible settings include Temporal, Continuous, March Time and 20 BPM tones that can each be set for Low or High volume settings. The candela settings can be field-configured for 15, 15/75, 30, 75, 110 cd. The candela setting is displayed through the front window for easy identification. All device settings are located on the back of the unit to prevent tampering.

The FHS-400C horn/strobes can be synchronized using an FACU or PSU with the MGC sync protocol or through an external sync module for compatibility with any UL/ULC FACU or PSU.

The FHS-400C Series notification appliances utilize a universal mounting plate that allows for mounting to a single gang, double gang, octagon, 4" junction or 4" square electrical box. The back plate allows the installer to mount the plate and connect the wire connections. The device attaches to the mounting plate and is secured by a single mounting screw. In addition, the FHS-400C can mount to the MGC BB-400 back box for surface mount applications.

Features

- Compact Design
- Advanced LED technology provides superior current draw performance
- Lower power consumption per device allows for more notification appliances per circuit and reduces the need for external power supplies
- Standard and High candela settings in one unit to meet virtually any application
 - 15, 15/75, 30, 75, 110 cd
- Multiple field-selectable audible settings
 - Temporal, Continuous, March Time and 20 BPM audible tones
 - High and Low volume settings
- Red or white finish
- Device settings are located on the back of the unit to prevent tampering
- Includes shorting clip that allows installers to test the wiring before the device is installed
- Supports 12 to 22 AWG
- Mount to MGC BB-400 surface mount back box, single gang, 4-inch square, double gang, octagon and 4-inch junction boxes
- All units include universal mounting plate
- For indoor applications

Agency Listings

- UL 1971
- UL 1638
- UL 464
- ULC-S525
- ULC-S526
- NFPA 72



Engineering Specifications

The horn/strobe shall be a MGC FHS-400C notification appliance for ceiling mount applications. The horn/strobe shall be of a low current draw design and operate at 24 VDC regulated or full wave rectified. The horn/strobe shall have two field selectable volume settings and a choice of four tone settings for temporal, continuous, march time or 20 BPM. The horn/strobe shall incorporate a Light Emitting Diode (LED) as the light source and have five field selectable settings of 15, 15/75, 30, 75, 110 candela. The candela settings shall show the candela selection in a visible location at all times when installed. Both the audible and candela settings shall be tamper resistant. The horn/strobe can be synchronized using an FACU or PSU with the MGC sync protocol or through the MIX-4050 or MRI-4050 sync modules for compatibility with any UL/ULC FACU or PSU. The horn/strobe shall utilize a mounting plate that allows the installer to pre-wire the mounting plate. The mounting plate shall mount on a single gang, double gang, octagon, 4-inch square box or MGC's BB-400 series back box. The horn/strobe shall be listed to UL standard 464, Audible Signaling Devices for Fire Alarm and Signaling Devices, UL standard 1638, Visible Signaling Devices for Fire Alarm and Signaling Systems and standard 1971, Signaling Devices for the Hearing Impaired. In addition, the horn/strobe shall be listed to ULC-S525, Audible Signal Devices for Fire Alarm Systems and ULC S526, Visible Signal Devices for Fire Alarm Systems.

400 Series Dimensions

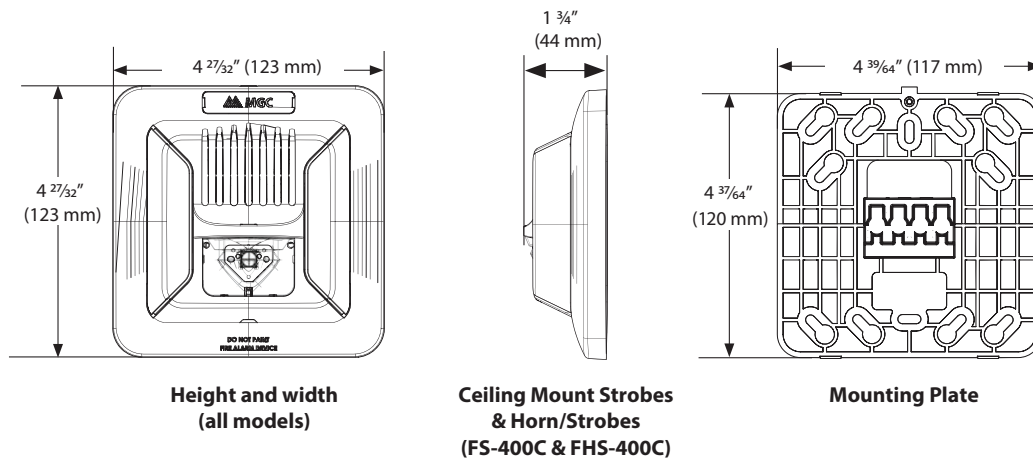

BB-400 Dimensions

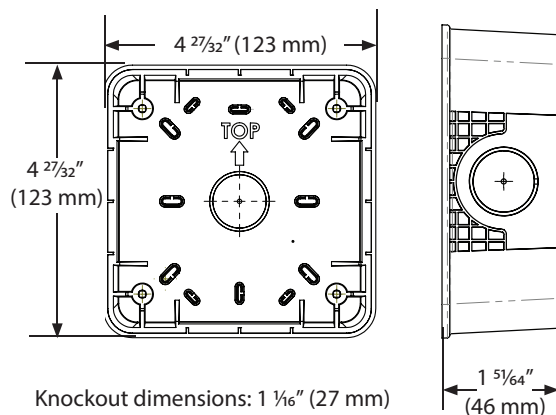

Audible/Visual Settings

DIP switches for the volume and signal rate

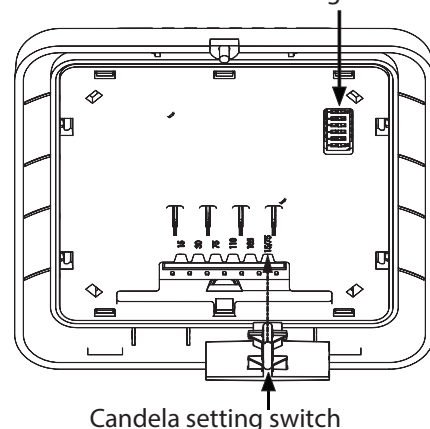

Device settings are located on the back of the unit to prevent tampering

Specifications

General Specifications

| | |
|-------------------------------|-----------------------------|
| Operating temperature | 0°C to 50°C (32°F to 122°F) |
| Humidity range | 0% to 93% |
| Strobe flash rate | 1 Hz |
| Nominal Voltage | Regulated 24 VDC / 24 VFWR |
| Operating Voltage Range (RMS) | 16 to 33 |
| Input terminal wire gauge | 22 AWG to 12 AWG |
| Installation environment | For indoor use only |

FHS-400C Ceiling Horn/Strobe Operating RMS Currents (mA)

| Candela | Regulated 24 VDC | | Regulated 24 VFWR | |
|---------|-----------------------------|------------------------------|-----------------------------|------------------------------|
| | Temporal Tone, High Volume* | Continuous Tone, High Volume | Temporal Tone, High Volume* | Continuous Tone, High Volume |
| 15 | 41 | 52 | 95 | 98 |
| 30 | 75 | 80 | 160 | 164 |
| 75 | 155 | 158 | 228 | 232 |
| 15/75 | 156 | 158 | 227 | 233 |
| 110 | 227 | 231 | 258 | 261 |

*Temporal tone volume is representative of March and 20BPM as well

Audible Ratings

dBa Reverberant Ratings per UL464 (dBa@10 ft)

| Sound Pattern | Volume | 16 VDC | Reg. 24 VDC | 33 VDC | 16 FWR | Reg. 24 FWR | 33 FWR |
|---------------|--------|--------|-------------|--------|--------|-------------|--------|
| Temporal | High | 82.2 | 84.9 | 84.6 | 76.8 | 79 | 80 |
| | Low | 75.5 | 80.5 | 80.2 | 71.8 | 75.1 | 76.6 |
| Continuous | High | 86.4 | 89.2 | 88.7 | 81.5 | 83.1 | 84 |
| | Low | 79.9 | 84 | 84.8 | 76.2 | 79.3 | 81.2 |
| 20 BPM | High | 79 | 81.3 | 81.6 | 74 | 75.1 | 76.1 |
| | Low | 72.3 | 76 | 76.7 | 68.9 | 71.7 | 73.3 |
| March | High | 83.2 | 86.4 | 85.7 | 79.2 | 80.6 | 81.4 |
| | Low | 76.9 | 80.9 | 81.7 | 73.3 | 76.2 | 78 |

dBa Anechoic Ratings per CAN/ULC-S525 (dBa@3 m)

| Sound Pattern | Volume | 16 VDC | Reg. 24 VDC | 33 VDC | 16 FWR | Reg. 24 FWR | 33 FWR |
|---------------|--------|--------|-------------|--------|--------|-------------|--------|
| Temporal | High | 90.2 | 93.2 | 93.2 | 84.4 | 87.1 | 88.5 |
| | Low | 83.7 | 87.4 | 88.3 | 78 | 82.2 | 84.5 |
| Continuous | High | 90.2 | 93.2 | 93.3 | 85.1 | 87.8 | 89 |
| | Low | 83.8 | 87.6 | 88.6 | 78.5 | 83 | 85 |
| 20 BPM | High | 90.3 | 92.9 | 92.9 | 84.4 | 87.2 | 88.6 |
| | Low | 83.6 | 87.3 | 88.3 | 78 | 82.2 | 84.5 |
| March | High | 90.2 | 92.9 | 92.9 | 84.4 | 87.1 | 88.4 |
| | Low | 83.7 | 87.4 | 88.3 | 78 | 82.2 | 84.4 |

ULC Directional Sound Characteristics

| Horizontal Axis | |
|-----------------|----------|
| ± 45° | -3 dbA |
| ± 61° | -6 dbA |
| ± 90° | -10 dbA |
| Vertical Axis | |
| ± 49° | -3 dbA |
| ± 61° | -6 dbA |
| ± 90° | -7.7 dbA |

Light Output Dispersion

| Degrees | % of Candela Rating | |
|---------------|-----------------------------|------------------------------|
| | Vertical Dispersion X-Plane | Vertical Dispersion, Y-Plane |
| ±0 | 150 | 155 |
| ±5 | 149 | 153 |
| ±10 | 149 | 152 |
| ±15 | 145 | 152 |
| ±20 | 139 | 146 |
| ±25 | 130 | 130 |
| ±30 | 121 | 122 |
| ±35 | 114 | 115 |
| ±40 | 111 | 111 |
| ±45 | 110 | 108 |
| ±50 | 110 | 108 |
| ±55 | 107 | 105 |
| ±60 | 100 | 101 |
| ±65 | 88 | 89 |
| ±70 | 72 | 72 |
| ±75 | 59 | 59 |
| ±80 | 60 | 61 |
| ±85 | 55 | 58 |
| ±90 | 42 | 45 |
| Compound ±45° | 79 | 83 |

Note: The values are shown as percentages of the rated light output at any candela setting.

Ordering Information

| Model | Description |
|-------------|----------------------------------|
| FHS-400C-RR | Ceiling Mount Horn/Strobe, Red |
| FHS-400C-WW | Ceiling Mount Horn/Strobe, White |
| BB-400R | Surface Mount Back Box, Red |
| BB-400W | Surface Mount Back Box, White |
| MIX-4050 | Mircom Synchronization Module |
| MRI-4050 | Secutron Synchronization Module |



Canada

25 Interchange Way Vaughan, ON L4K 5W3
Telephone: (905) 660-4655 | Fax: (905) 660-4113

U.S.A.

4575 Witmer Industrial Estates Niagara Falls, NY 14305
Toll Free: (888) 660-4655 | Fax Toll Free: (888) 660-4113

www.mircom.com



This document is provided by Mircom Technologies Ltd., MGC Systems Corp., or their affiliates, subsidiaries and brands, for convenience or marketing only and does not describe products or services technically. For technical information refer to technical manuals. We do not make representations or warranties regarding this information, including as to completeness or accuracy. We may change these contents at any time and reserve all rights in the contents, including copyrights, trademarks and other intellectual property.

CAT. 5364

Rev. 1