

SECTION 5: DEVICE INSTALLATION RECOMMENDATIONS

Warning: If possible, avoid mounting device on any metal surfaces

A. DEVICE OUTSIDE CALL BOX:

1. Clean surface to which device will be installed with surface cleaning solvent like isopropyl alcohol or heptane
2. Peel off liner on two 3M high temperature stretch release adhesive
3. Place device in desired location on wall
4. Press and hold for 30 sec for device to be securely adhered in position



B. DEVICE INSIDE CALL BOX:

1. Clean installation surface with cleaning solvent like isopropyl alcohol or heptane.
2. Take off liner on 3M Stretch Release Liner
3. Alternatively, once all wires have been connected, place device in the call box so its position is secure without the requirement of fasteners to install device



ETHERNET WIRE (IF APPLICABLE)

Once wires are connected to plug in terminal, if ethernet connector is available, insert the ethernet's wire into connector array.

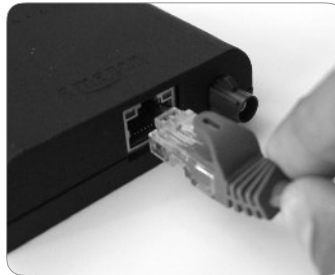

POWER WIRE

DEVICE OUTSIDE CALL BOX:

Connect to power by inserting micro USB plug on the DC power supply brick



DEVICE INSIDE CALL BOX:

Connect to power through PS1 and PS2 (see section 2) on the connector array

CLOUD CONNECTED GATEWAY INSTALLATION GUIDE

LEO-LITE

V 1.0, JUNE 2020



SECTION 6: FCC/CE DOCUMENTATION

This device has not been authorized as required by the rules of the Federal Communications Commission. This device is not, and may not be, offered for sale or lease, or sold or leased, until authorization is obtained.

CABLE LABEL INSTALLATION PROCESS

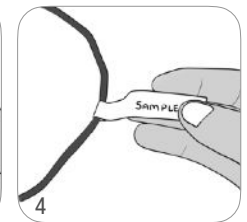
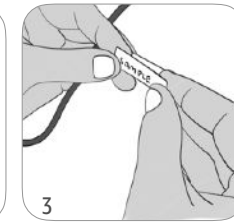
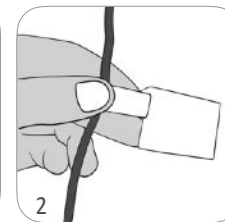
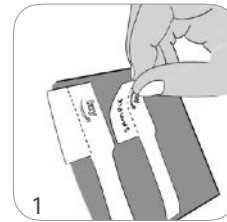

CLOUD CONNECTED GATEWAY INSTALLATION GUIDE

SECTION 1: KIT CONTENTS

- A. 1 x 8 pin, 3.5mm pitch KF2EDGK
- B. 1 x USB 5V DC wall supply
- C. 1 x 5ft micro USB cable
- D. 4 x Cable labels
- E. 1 x Puck Antenna
- F. 1 x Stick Antenna
- G. 1 x Leo-Lite Device

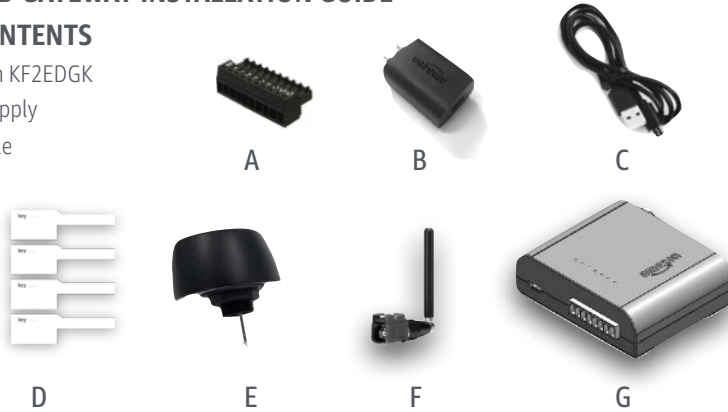

Additional tools / equipment required

- Wires / Cables for connector terminals
- Optional: RJ45 Ethernet Cable (*length less than or equal to 3 meters*)

Manufactured by: Amazon

Website: www.amazon.com

Contact Name: KfB Tech Support

Contact Number: 1-833-245-5068

Email: oneclickaccess-cx@amazon.com

SECTION 2: WIRE INSTALLATION - PLUG IN TERMINAL

1. Strip insulation to expose about 0.25" of wire (18 - 22 AWG)
2. Use flat head screw driver to release screws on 8 pin plug in terminal connector
3. Place wire in desired opening
4. Tighten screw to hold wire in place, tug on wire to ensure it is secure
5. Repeat for all additional wires
6. Plug in 8 pin connector to mating connector on the device
7. Use cable labels to identify wires appropriately (Instructions provided)

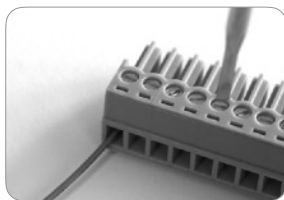
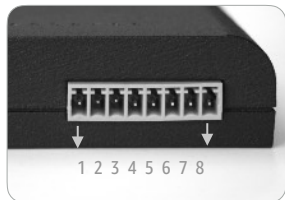

8 POSITIONS ON PLUG-IN
TERMINAL CONNECTOR

Relay connections are
interchangeable

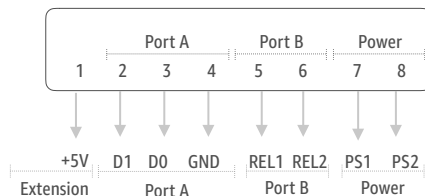

SECTION 3: ANTENNA CONNECTION

INSIDE CALL BOX MOUNT: PUCK ANTENNA

1. Unscrew the nut and washer from puck antenna (G47.A.0358721)
2. Remove 1/2" Knockout on the bottom of the call box
3. Insert the cable through the knock out you removed, ensuring the puck antenna is outside the callbox
4. Re-screw the washer and nut to fix the antenna in place on the inside of the callbox so it's tightly mounted onto the callbox
5. Attach the antenna connector to the device's antenna port until it locks in place

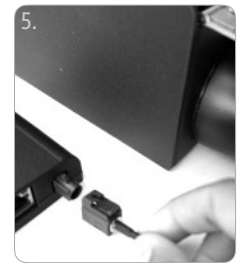
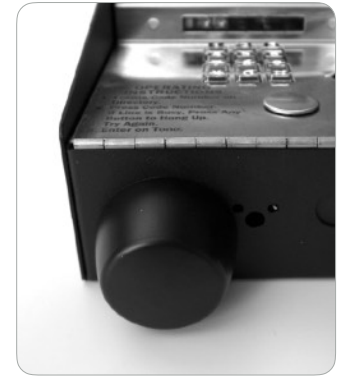

OUTSIDE CALL BOX, WALL MOUNT: STICK ANTENNA

Insert the terminal mount antenna (TG.08.0723) into the antenna connector until the connector is locked in place as shown. Adjust antenna to point away from any metal surfaces.

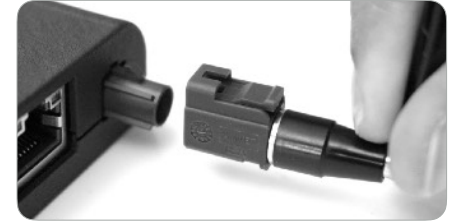

SECTION 4: LED AND CONNECTOR TERMINAL INDICATORS

1. POWER: Solid light indicates device is powered
2. CELL:
 - Red indicated no cellular coverage
 - Yellow indicated low cellular coverage
 - Green indicated good cellular coverage
 - White indicated the device is using Ethernet
 - Blue indicates attempting to get cellular strength
3. CONNECTED: Flashing light indicates device has internet connectivity
4. RUNNING: Flashing light indicates device is running as programmed
5. RECORDING: Solid light indicates device is listening for access credential
6. DOORS 1-2: Solid light On for 2 second indicates respective door is opening at that time
 - DR1
 - DR2

- PWR
- CELL
- CON
- RUN
- REC
- DR1
- DR2