

TX3 NANO QUICK START

TX3 Nano dimensions:
219 mm x 147 mm x 47 mm
(8 19/32" x 5 3/4" x 1 27/32")
Mounting plate dimensions:
200 mm x 140 mm (7 27/32" x 5 1/2")

WARNING:
Use the TX3-NANO-BB backbox for outdoor installations.
Do not mount the TX3 Nano in direct sunlight.
Disconnect the power before wiring.

For more information, see LT-6637 and LT-1194 on the included USB flash and <http://www.mircom.com/tx3nano>

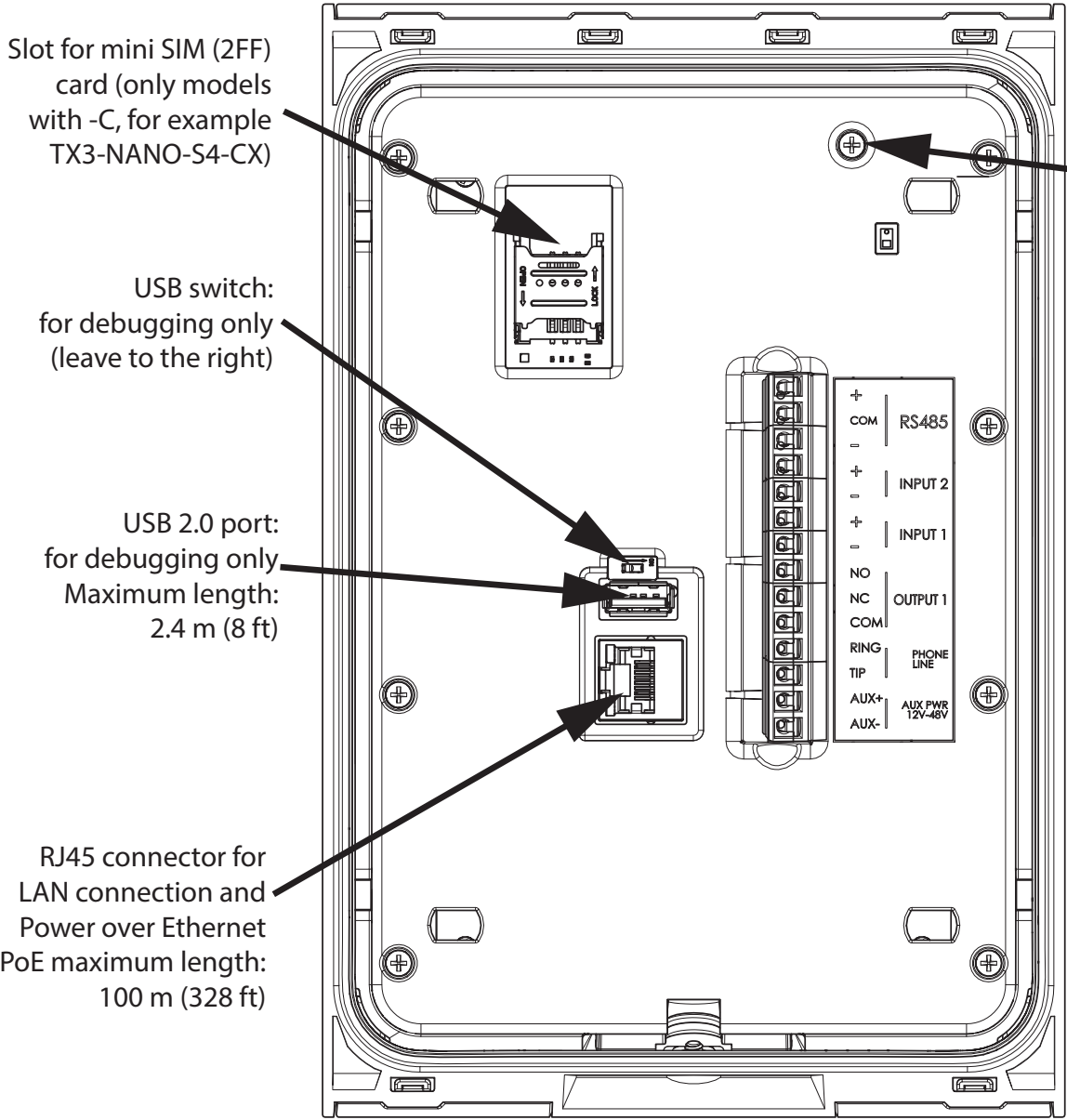

For more information, see LT-6637 and LT-1194 on the included USB flash and <http://www.mircom.com/tx3nano>
Mircom Tech Support: 1-888-MIRCOM5 (888-647-2665) techsupport@mircomgroup.com

MOUNTING

1 Apply outdoor-rated weatherproof silicone to groove in mounting plate

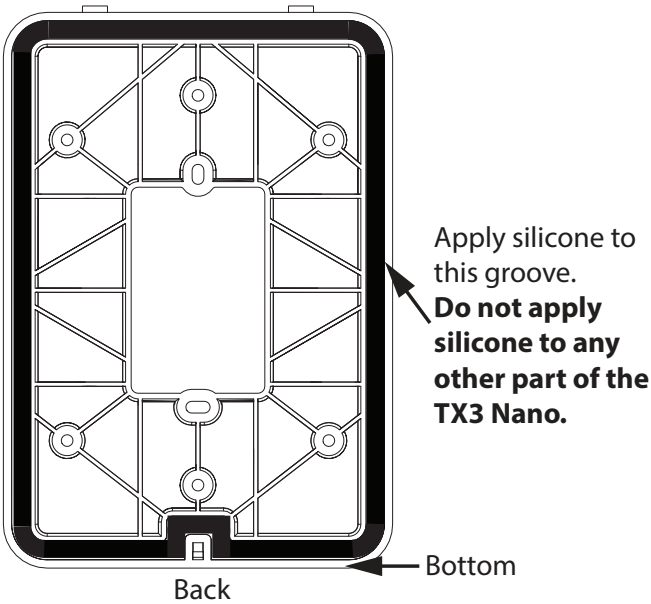

4 Attach TX3 Nano to mounting plate

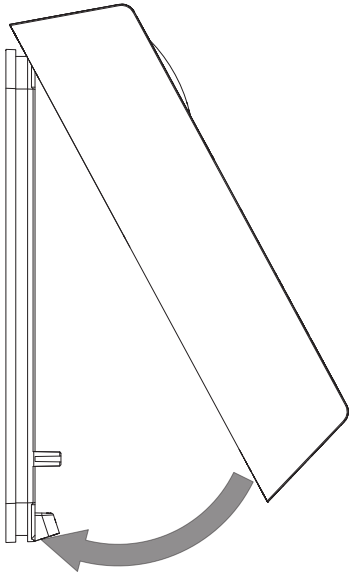

2 Attach mounting plate to wall

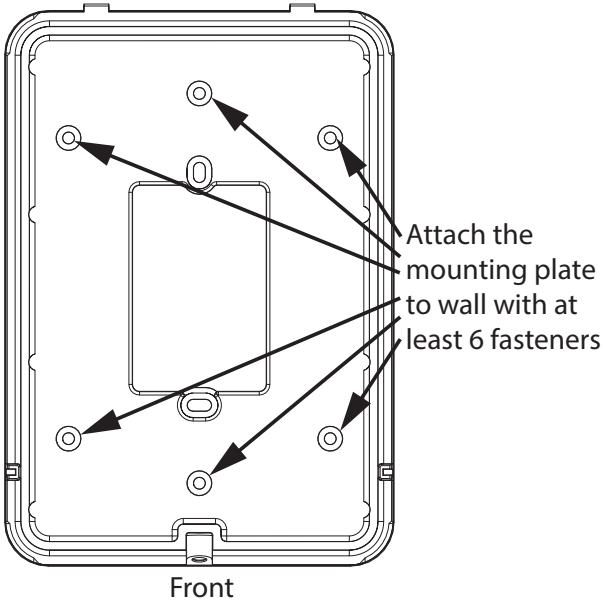

5 Insert security screw

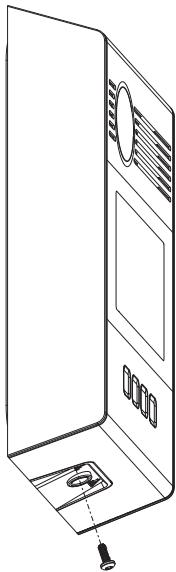

3 Use 2 screws to align gang box with mounting plate

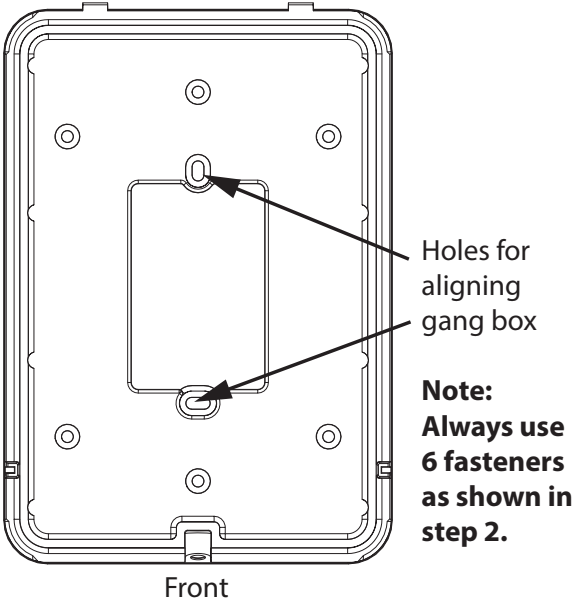

6 Configure

1. Press and hold the Home button for 10 seconds. The TX3 Nano's IP address and MAC address appear on the display.
2. On a computer on the same local area network as the TX3 Nano, open Google Chrome and type the IP address of the TX3 Nano, and then press enter.
Username: **admin**
Password: **admin**

WARNING
To ensure the security of occupants, change the admin password from its default setting. See LT-1194 on the included USB flash for details.

LT-6152 rev 3.4 © Mircom 2018. Printed in Canada
Subject to change without prior notice
See <http://www.mircom.com/tx3nano> for the latest information