

NOTES

- 1) MATERIAL: BACKBOX - 18GA (0.048") SATIN COATED STEEL, PAINTED
DOOR - 18GA (0.048") SATIN COATED STEEL, PAINTED
HINGE - 20GA (0.037") STAINLESS STEEL
WINDOW - 0.125" THICK CLEAR LEXAN
UL 94V-0 RATED
- 2) INSULATE CONDUIT ENTRY/OPENING AND MOUNTING HOLES
WITH FOAM/SILICON GLUE.
- 3) CONNECT CHASSIS GROUND WIRE TO EARTH GROUND.

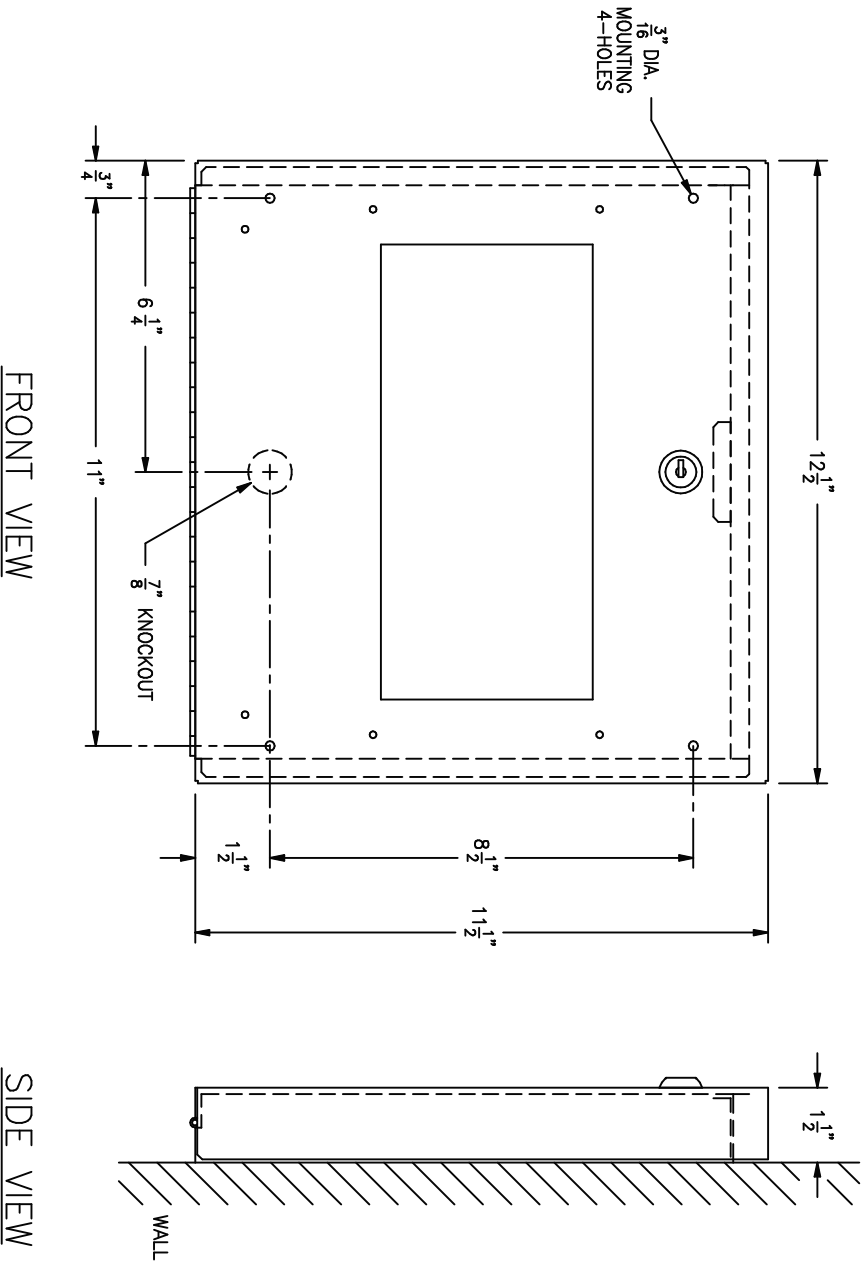

MODEL BB-1001WP (WEATHER-PROOF ENCLOSURE) INSTALLATION INSTRUCTION / SPECIFICATIONS